

Tuesday 13 November
Cloth Hall Court, Leeds

PROGRAMME

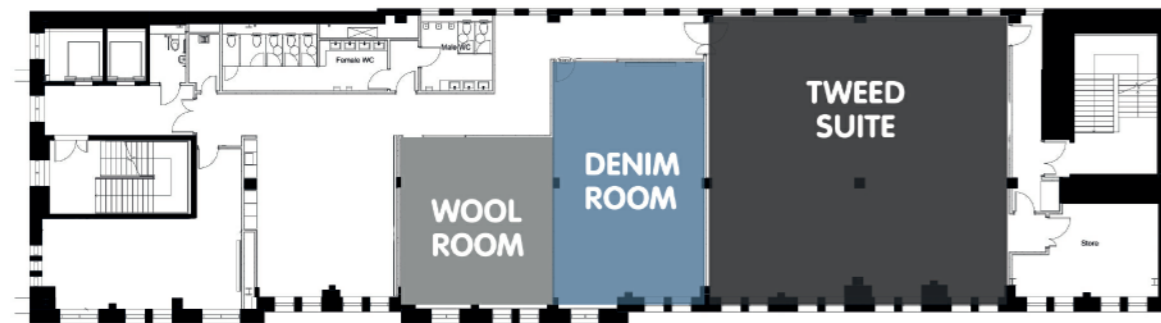

SECOND FLOOR



FIRST FLOOR



GROUND FLOOR - REGISTRATION AND EXHIBITORS



#UKPHC18

@PassivhausTrust

Conference Proceedings

9.30 - 11.00 Zero Carbon Policy

HERRINGBONE FLOOR 1 Welcome from the Chair **Jon Bootland**, PHT

Zero carbon building code and Passivhaus in Vancouver **Sean Pander**, Green Building Manager, City of Vancouver
A low carbon future - Leeds' Climate Commission **Tom Knowland**, Head of Sustainable Energy & Climate Change, Leeds City Council
Glasgow's climate change strategy and journey to Passivhaus **Michelle Mundie**, Group Manager (Investment), Glasgow City Council
Greater Manchester's approach to zero carbon **Mark Atherton**, Assistant Director Environment, Greater Manchester Combined Authorities
Setting higher standards Panel discussion

11.00 - 11.30 Coffee break

11.30 - 12.45 Case studies from near to zero

HERRINGBONE FLOOR 1 **Residential case studies**
Chair: Chris Herring, Green Building Store

Goldsmith Street - near zero energy approach in volume housebuilding **Dave Moorcroft**, Norwich City Council & **James Turner**, Mikhail Riches
Cannock Mill Co-housing - addressing social needs in near and zero carbon housing
Anne Thorne, Anne Thorne Architects
Leeds Climate Innovation District - large-scale zero carbon housing
Jonathan Wilson, CITU

TWEED FLOOR 2 **Non-domestic case studies**
Chair: Lynne Sullivan, LSA Studio

Complex near zero energy buildings worldwide **Gergina Radeva**, Passivhaus Institute
Leicester Cathedral - addressing social needs in zero carbon buildings: integration with heritage
Josh McCosh, vHH Architects
Hackbridge Primary School - zero carbon case study
Gareth Selby, Architype

12.30 - 14.00 Lunch break

14.00 - 15.15 Routes to zero carbon

HERRINGBONE FLOOR 1 **New build**
Chair: Jonathan Hines, Architype

Virido, Cambridge
Tom Dollard, Pollard Thomas Edwards & **Chris Gorse**, Leeds Beckett University
Cameron Close
Sally Godber & Caroline Martin, WARM: Low Energy Building Practice

TWEED FLOOR 2 **Retrofit**
Chair: Marion Baeli, PDP London

Approaches to EnergieSprong
John Pratley, Gardner Stewart Architects
David Adams, Melius Homes
Whole house step-by-step approaches
Harry Paticas, Arboreal Architecture
John Pratley, Gardner Stewart Architects

DENIM FLOOR 2 **Passivhaus self-build**
Chair: John Palmer, PHT

Old Forge
Eric Parks, Buckrose Ecological Architects
Old Byres EnerPHit
Sarah Price, Enhabit & **Richard Clayson**, owner
Haven Cottage
Andrew Goodman, Good Architecture
Camden Town Passivhaus
Rafael Delimata & Hagop Heath-Matossian, Bow Tie Construction
Graven Hill
Martin Rinvoluceri, Beattie Passive

EXPO ACCESS

WOOL FLOOR 2 **Technical session**
MVHR specification, installation and commissioning **Mich Swainson**, BRE

15.15 - 16.00 Coffee break

16.00 - 17.15 Delivering comfort, quality & performance

HERRINGBONE FLOOR 1 **Planning & early design decisions**
Chair: Emma Osmundsen, Exeter City Council

Costs and viability assessment
Sarah Price, Enhabit
Approach to a whole estate
Tom Heel, University of Oxford
Energy and renewables strategy
Gwilym Still, Max Fordham

TWEED FLOOR 2 **Details, construction & beyond**
Chair: Nick Grant, Elemental Solutions

Integrating solar PV and battery storage into low energy buildings
Christian Jardine, Joju Solar
Delivering quality via off-site manufacturing
Jasper Meade, PYC Group
Maintenance plans and occupant comfort
Dean Myers, One Manchester

DENIM FLOOR 2 **Passivhaus 'futures'**
Chair: Kym Mead, PHT

Fulford Passivhaus
Phil Bixby, Constructive Individuals
Little Pits
Jae Cotterell, Passivhaus Homes
Nailsea Passivhaus
Piers Sadler, Piers Sadler Consulting
Leyburn Passivhaus
Adam Clark, Halliday Clark Architects

EXPO ACCESS

WOOL FLOOR 2 **Technical session**
Air-tightness, including repeat testing 10 years on **Paul Jennings**, Aldas

HERRINGBONE FLOOR 1 17.30 - 18.00 Making the journey to zero carbon: panel discussion

MERCHANT HALL FLOOR 0 18.00 - 19.30 Drinks and networking
Passivhaus Student Competition Awards Ceremony

Exhibitors

Kingspan Insulation

Stand 1

Kingspan Insulation is a market leading manufacturer of optimum, premium and high performance rigid insulation products and insulated systems for building fabric and building services applications. Kingspan Insulation is one of the founding members of the Passivhaus Trust and is at the forefront of the low energy building drive, helping architects and developers get the most energy efficient building envelope performance whilst taking up minimal space. Its products are among the most thermally efficient and technically advanced insulation materials available and have many advantages over traditional insulation materials.

www.kingspaninsulation.co.uk



Munster Joinery

Stand 2

Munster Joinery is amongst the largest manufacturers of energy efficient windows and doors in Europe. Founded in 1973, the company has grown year on year with the continuous development of new products, materials and processes. The company has a 940,000sq ft. production facility in Ireland and another 230,000sq ft. in Warwickshire in the UK. In recent years Munster Joinery has focused on developing energy efficient products through green and sustainable processes and operations. All of the products are designed for optimal thermal performance with U-values as low as 0.47 W/m²K. Several window systems, all of which are designed, developed and manufactured in house are now Passive House certified.

www.munsterjoinery.co.uk



Econekt

Stand 3

Econekt are proud to be the exclusive UK partner for Izodom 2000 products. Izodom 2000 Polska was set-up in 1991 with a focus on the production of low energy and Passivhaus building products, leading to the eventual formation of the certified (PHI 2018) Passivhaus building system. Now with production and manufacturing facilities globally, Izodom produce one of the most advanced ICF based systems available on the market. With a range of over one hundred and forty individual system components, through three levels of energy performance there is an Izodom product option for every project.

www.econekt.co.uk

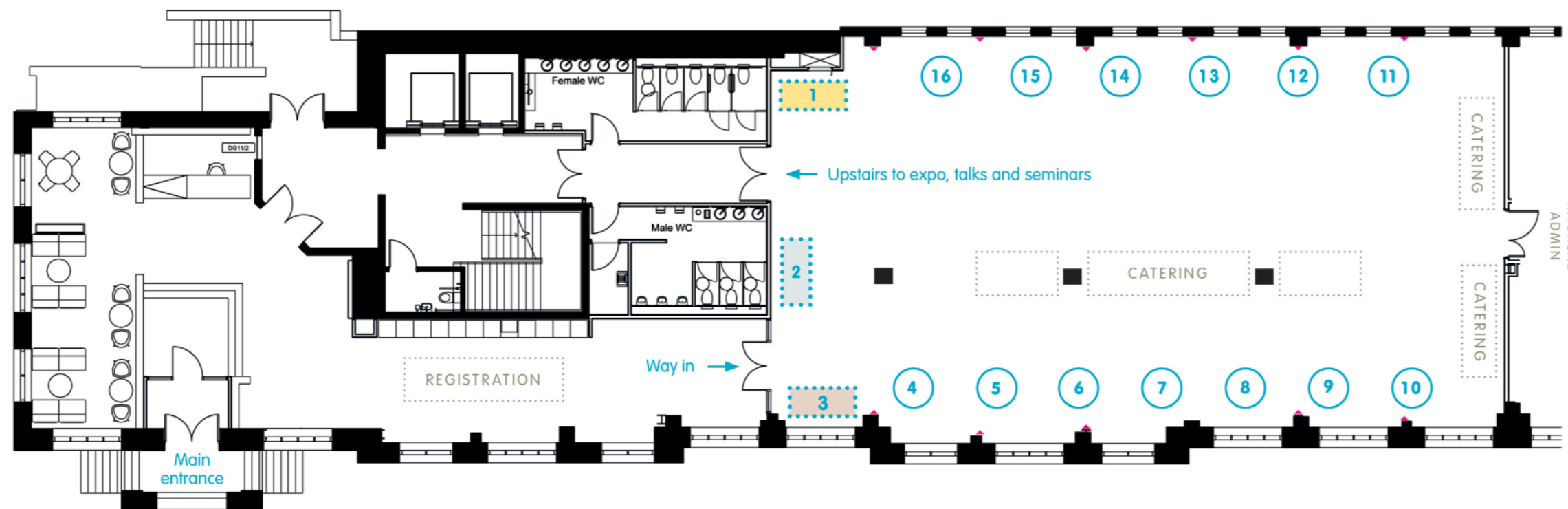

MERCHANT HALL EXPO

Airflow Developments

Stand 14

Airflow Developments has been producing high-quality ventilation products and accessories for over 60 years. A specialist in commercial and residential Mechanical Ventilation with Heat Recovery (MVHR), Airflow can provide you with an extensive range of Passive House approved units that supply fresh, filtered air whilst removing polluted air from the built environment. Our Adroit internet controllable Passive House approved residential MVHR units all recover up to 93% of the otherwise wasted heat and are compatible with our zero leakage, SAP approved semi-rigid ducting: Airflex Pro. Airflow's Passive House approved commercial MVHR units are available with rotary wheel and counterflow heat exchangers.

www.airflow.com



ATTMA

First floor

ATTMA is a Government authorised not-for-profit organisation that accredits its members for both air tightness testing and sound insulation testing. ATTMA, formed in 2002, it also operates as the largest trade association for air tightness testing carrying out research, writing technical standards and ensuring competence in the industry is always kept high. ATTMA's Lodgement software collects data from more than 85% of all tests conducted in the UK as well as testing internationally from the UAE, Poland, Spain, Australia and New Zealand. Data from their software is used to analyse the industry and set targets going forward. The Exhibition stand will be manned by Paul Carling, ATTMA Technical Manager who is a world leader in Complex air tightness testing and was the majority author of ATTMA TSL4:2018.

www.attma.org



CVC Direct

Stand 5

CVC Direct are the UK stockists for the Passivhaus Certified range of Heat Recovery units from Brink Climate Systems and can advise on your Passivhaus ventilation requirements. We stock a selection of units from the range, plus spares and consumables. We are a family run business which has been trading for over 25 years and specialises in Heat Recovery Ventilation, Central Vacuum Systems and Ground/Air Heat Exchange (GAHE) ducting. We offer free advice, free planning and quotations. For the ventilation systems CVC Direct are able to produce (at a cost) detailed 3D drawings and specifications. Ask for our free 'Guide to Planning and Installing a Heat Recovery System'.

www.cvcdirect.org



Ecology Building Society

Stand 8

Ecology Building Society provides ethical savings accounts and green mortgages for properties that benefit the environment. The prime focus of the Society is to promote an ecological approach to the built environment in the UK, and thereby foster sustainable communities. We seek to minimise energy use and waste in both our office and business practices. Our mortgage product range includes C-Change Discounts for residential borrowers, which offer a 1.25% discount off our Standard Variable Rate for Passivhaus certified homes for the lifetime of the mortgage, small scale development loans and commercial mortgages for developers of Passivhaus standard properties.

www.ecology.co.uk



Green Building Store

Stand 16

Green Building Store offers products and support for Passivhaus and low energy homes and buildings, including triple glazed timber windows and doors and advanced MVHR heat recovery ventilation, specialist airtightness & insulation products and consultancy and building services. With over 20 years' experience of working on low energy homes and buildings, Green Building Store combines technical expertise with outstanding personal service and aftercare.

www.greenbuildingstore.co.uk



ICF Supplies

Stand 11

ICF Supplies is the UK's largest distributor of NUDURA ICF products. Two high-density polystyrene panels are connected via webs made from 100% recycled products, forming a continuous hollow core for concrete and steel placement. The thermal mass allows buildings to maintain comfortable temperatures effectively. NUDURA addresses cold bridging efficiently, is inherently airtight and offers U values as low as 0.11 making it a perfect fit for Passivhaus.

www.icfsuppliesltd.co.uk



Lamilux

Stand 7

Lamilux offer industry leading roof light and roof glazing solutions. Our product range includes; rooflight domes, continuous barrel vault roof-lights, EN 12101-2 smoke vent AOV's and large glazed atria. We specialise in the supply and installation of large flat glass roofs. Our rooflight solutions are all free of thermal bridges and we have systems independently certified to the Passivhaus standard.

www.lamilux.com



Latham Timber

Stand 12

James Latham is an industry leader in supplying sustainable panel products, hardwood, joinery-quality softwood, performance doors, solid surface, cladding and decking and offers probably the most comprehensive and varied timber-based product range available in the market. Latham's comprehensive range of innovative performance door cores includes the Moralt FERRO Passiv 98mm also with fire rating and high-acoustic options, which carries Passive House certification for low-energy and Passive houses. This range is exclusively available in the UK through James Latham's 10-strong nationwide network of depots.

www.lathamtimber.co.uk



Magmatech

Stand 4

MagmaTech develops and manufactures thermally insulating fixings and structural connections designed to remove thermal bridging from super insulated buildings. This includes the Teplo range of low conductivity basalt fibre wall ties. The Teplo range of low conductivity wall ties improves the thermal efficiency of walls by replacing metal wall ties, which act as a thermal bridge through the insulation layer. MagmaTech's wall ties are commonly used in very low energy, Passive Haus and Zero Carbon certified buildings. Thermally broken connections between most construction materials are possible (including masonry, concrete, steel and timber).

www.magmatech.co.uk



Nilan

Stand 9

Nilan develops and manufactures premium-quality, energy-saving ventilation and heat pump solutions that are beneficial to the environment and provide a healthy indoor climate and low-level energy consumption. Since the company was founded in Denmark in 1974, Nilan's activities have spread steadily to international markets. Today, the market has recognised our skills and approved our products. We are now represented across most of Europe and continue to expand.

www.nilan.dk



PYC Group

Stand 15

From Passivhaus design and construction to high quality joinery finishes, we pride ourselves in creating beautiful homes. With over 25 years specialising in low energy timber frame buildings, we use natural materials that are durable and robust. Our expert team offer bespoke support for self-build projects or the complete turn-key package. At our new House Building Factory in Wales we build fully engineered, insulated and airtight closed panels using Warmcel and timber I-beams. Pyc Insulation are the official distributors of Warmcel cellulose fibre insulation for timber frame in the UK and Ireland. Warmcel offers impressive U-values and airtightness, exceeding building regulations and reaching Passivhaus standards.

www.pycgroup.co.uk



Schöck

Stand 13

Schöck has grown to become Europe's leading supplier of innovative structural load bearing insulation products. The main product is the Schöck Isokorb® – a thermal break for various types of cantilever constructions in new buildings and for renovation. Alongside product innovations, Schöck also places particular importance on a broad portfolio of services, such as our CAD/BIM-Service, Design Software, our 24h delivery service for goods in stock, our engineering hotline in the Design Support department or our Schöck field service.

www.schoeck.co.uk



SIGA

Stand 6

SIGA is leading in the development, production and distribution of products free from residential toxins for the air and windtight building envelopes with the goal to build a world of zero energy loss buildings. SIGA-sealed buildings are characterized by low heating and ventilation costs, higher standard of comfort without drafts and protection from mould. Know-how, quality, innovation and the consistent striving for sustainability are some of the recipes for the success of the family business. Personal customer contact with building and construction professionals is ensured in over 30 countries around the world by 200 field staff belonging to the company.

www.siga.swiss



Passive Purple

Stand 10

Passive Purple offer the complete airtightness package of supply and install of Passive Purple Liquid Vapour Control Membrane. We can work with you to design your airtightness details and get air tests to Passivhaus standards of 0.6 ach or lower. We also have our own in-house Certified Passivhaus consultants on hand for the more complex projects. Passive Purple is unlike any Vapour Control membrane you will come across and it needs no staples or tapes, unlike other brands of paper membranes. Passive Purple can also offer training and advice for people who want to install Passive Purple themselves, supplying the whole of the UK.

www.passivepurple.co.uk



#UKPHC18

@PassivhausTrust